

DESIGNER RANGE 413 SYSTEM

Thermaview™ Awning/Casement Window



Date: Feb 2013
Replaces: Apr 2012

Not to scale

00-015 – Keyed Chain Winder



02-082 – Bulb Seal (PVC)

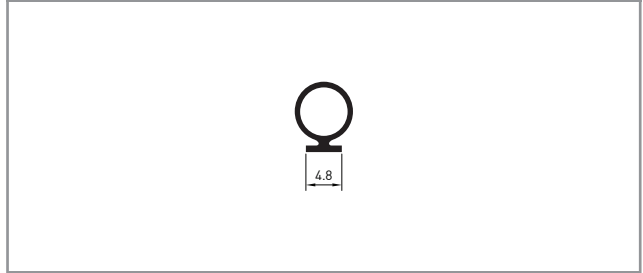

02-153 – V Seal (Mullion)

Suitable for COM-020, COM-041,
700-646, 400-314



04-108 – Glazing Wedge



04-118 – 18mm Glazing Wedge (615 System)

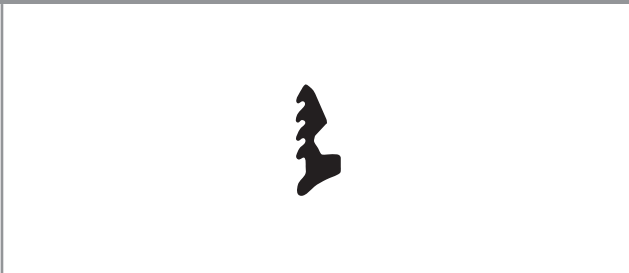

04-234 – Glazing Wedge (400-661)

Suitable for 400-661



05-062 – Corner Stake (400-661)

Suitable for 400-661,
LSS 401

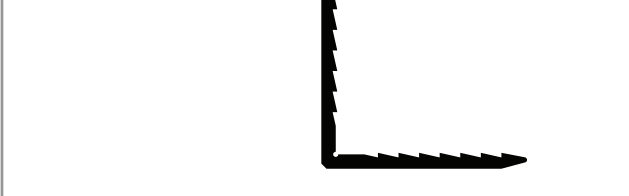

05-146 – Corner Stake (400-655)

Suitable for 400-655,
370-126, 900-019



05-541 – Gasket (405-561)

For 413 System

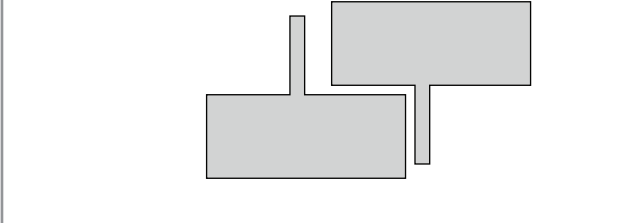

05-673 – Corner Stake

Suitable for 400-673

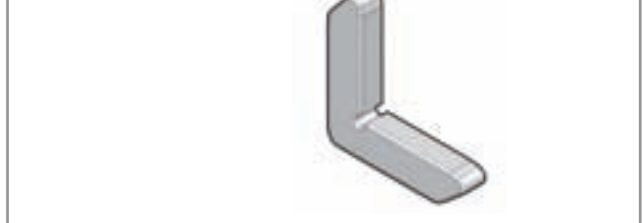

Up to date stock availability can be viewed at www.lidco.com.au/indices

Not to scale

09-271 – Turn Button Long (Black)



09-278 – Flexible Handle (black)

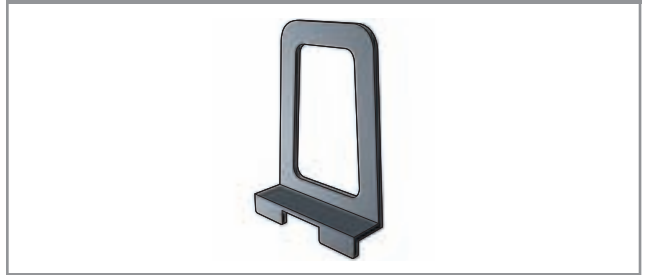

18-201 – Stainless Steel Restrictor



19-300L – 6mm Cam Handle (Left)



19-300R – 6mm Cam Handle (Right)



19-301L – 6mm Lockable Cam Handle (Left)



19-301R – 6mm Lockable Cam Handle (Right)





Up to date stock availability can be viewed at www.lidco.com.au/indices



DESIGNER RANGE 413 SYSTEM

Thermaview™ Awning/Casement Window

Not to scale

Casement Window Stay (Stainless Steel)  	Part Number	Length	Maximum Opening Angle	Maximum Sash Weight	Maximum Sash Width	Notes
	18-171	230mm	90°	25kg	800mm	
	18-171NF	230mm	90°	25kg	***	Non-friction
	18-183	430mm	90°	40kg	1000mm	
	18-183NF	430mm	90°	40kg	***	Non-friction

For **Casement Window** 373, 413, 710, 715, and 718 Systems

Awning Window Stay (Stainless Steel)  	Part Number	Length	Maximum Opening Angle	Maximum Sash Weight	Maximum Sash Height	Notes
	18-172	200mm	40°	10kg	600mm	
	18-172NF	200mm	40°	10kg	***	Non-friction
	18-173	350mm	30°	20kg	800mm	
	18-173NF	350mm	30°	20kg	***	Non-friction
	18-174	500mm	25°	30kg	1800mm	
18-174NF	500mm	25°	30kg	***	Non-friction	

For **Awning Window** 373, 413, 710, 715, and 718 Systems

Awning Window Stay (Aluminium)  	Part Number	Length	Maximum Opening Angle	Maximum Sash Weight	Maximum Sash Height	Notes
	18-190	230mm	45°	6kg	750mm	
	18-192	230mm	45°	10kg	***	Non-friction
	18-191	330mm	35°	9kg	1000mm	
	18-187	420mm	20°	15kg	1800mm	
	18-187	420mm	20°	20kg	1500mm	
18-187	420mm	20°	43kg	1200mm		

For **Awning Window** 373, 413, 710, 715, and 718 Systems

*** Based on weight rating of the winder

Up to date stock availability can be viewed at www.lidco.com.au/indices