

*Lead times may apply

Up to date stock availability can be viewed at www.lidco.com.au/indices

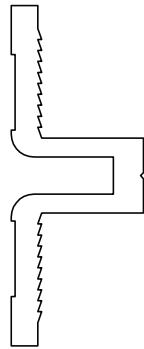

700-905
Glazing Base
 $I_{xx} = 6.60 \times 10^3 \text{ mm}^4$

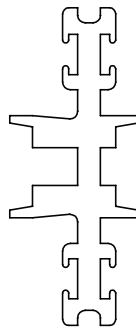

700-921
Clamp Bar
 $I_{xx} = 2.20 \times 10^3 \text{ mm}^4$

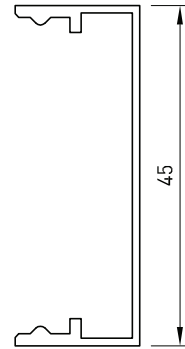

700-900
Cover Cap
 $I_{xx} = 2.80 \times 10^3 \text{ mm}^4$

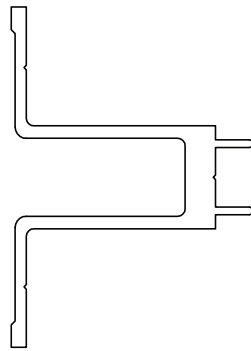

700-906
Glazing Base - IGU
 $I_{xx} = 20.67 \times 10^3 \text{ mm}^4$

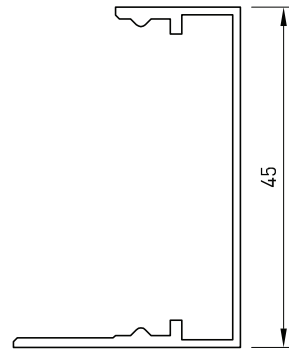

700-922
Cover Cap
 $I_{xx} = 7.62 \times 10^3 \text{ mm}^4$

Up to date stock availability can be viewed at www.lidco.com.au/indices

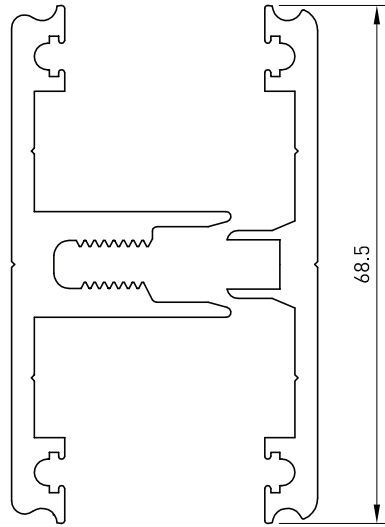

600-860 *
Glazing Base
 $I_{xx} = 21.8 \times 10^3 \text{ mm}^4$

600-861 *
Clamp Bar
 $I_{xx} = 1.40 \times 10^3 \text{ mm}^4$

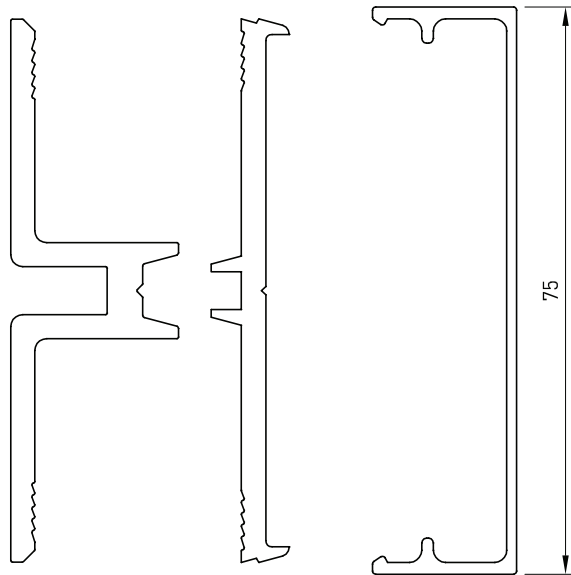

600-477 *
Glazing Base
 $I_{xx} = 13.68 \times 10^3 \text{ mm}^4$

600-478 *
Clamp Bar

600-479 *
Cover Cap
 $I_{xx} = 5.67 \times 10^3 \text{ mm}^4$

*Lead times may apply

Up to date stock availability can be viewed at www.lidco.com.au/indices