

Glazing Details

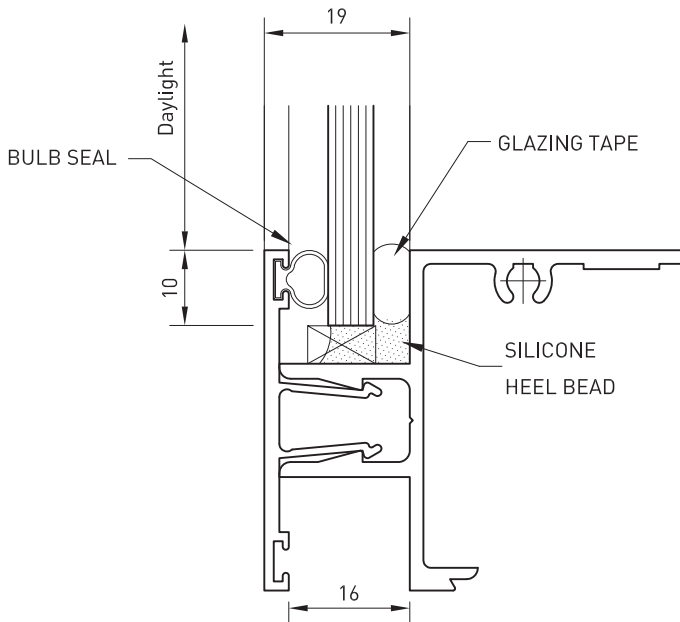

Part Section Through Sill

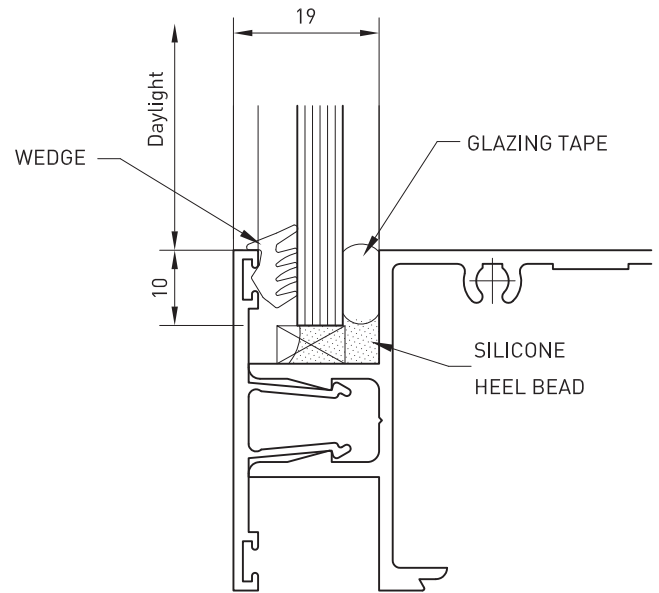

Part Section Through Sill

Glass Thickness	Bulb Seal	Glazing Tape
6mm/6.38mm	02-082	4.8x9mm
8mm	02-082	3.2x9mm
10mm	02-082	1.6x9mm

Glass Thickness	Wedge	Glazing Tape
6mm/6.38mm	04-142	4.8x9mm
8mm	04-108	3.2x9mm
10mm	04-105	1.6x9mm

Due to tolerances on glass, metal and glazing materials, these recommendations should be taken as an indicative guide only and should be verified by test glazing.

Glazing Details

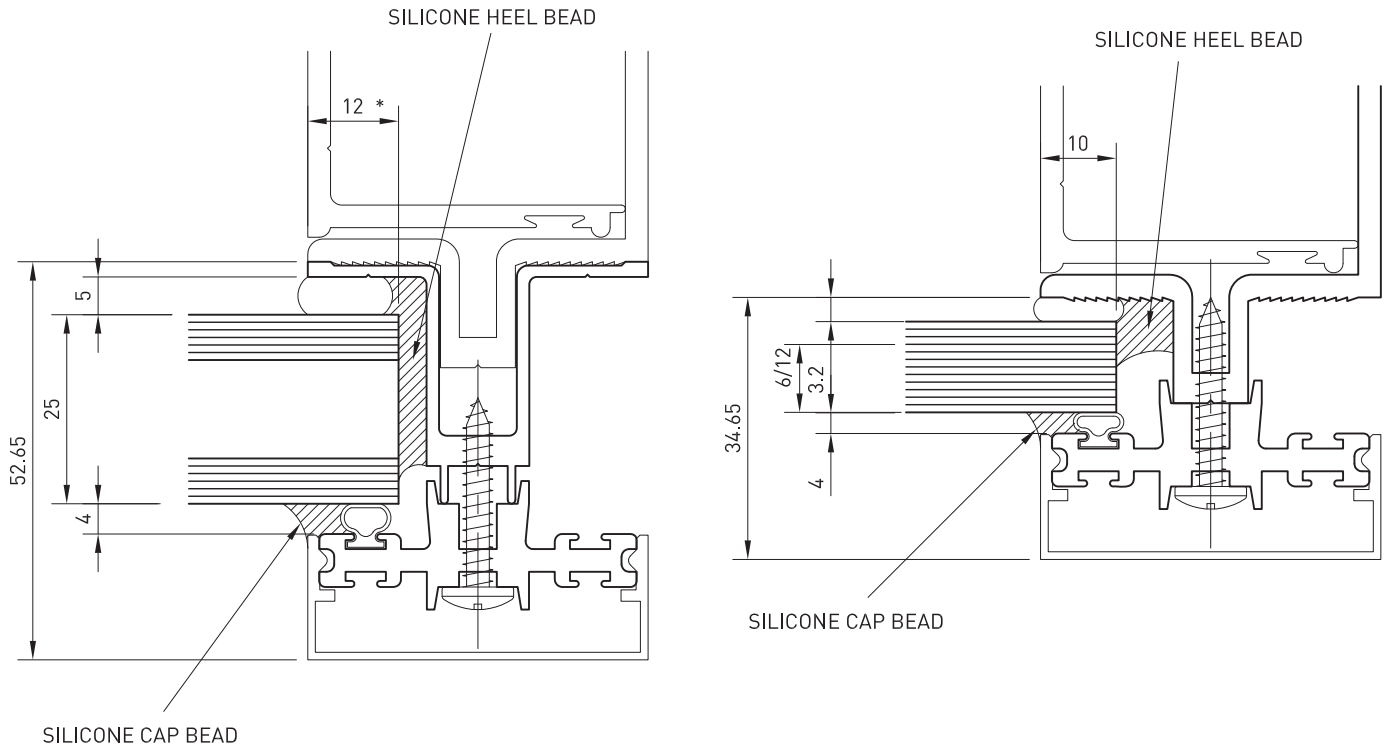

Note: Ensure minimum 12mm glass cover for all double glazed units

Glass Thickness	Bulb Seal	Glazing Tape	Rebate Width
6mm/6.38mm	02-082	3.2x9mm	14mm
8mm	02-082	1.6x9mm	14mm
10mm	02-082	4.8x9mm	18mm
12mm	02-082	1.6x9mm	18mm
24mm/25mm	02-082	4.8x9mm	34mm

Glazing Details

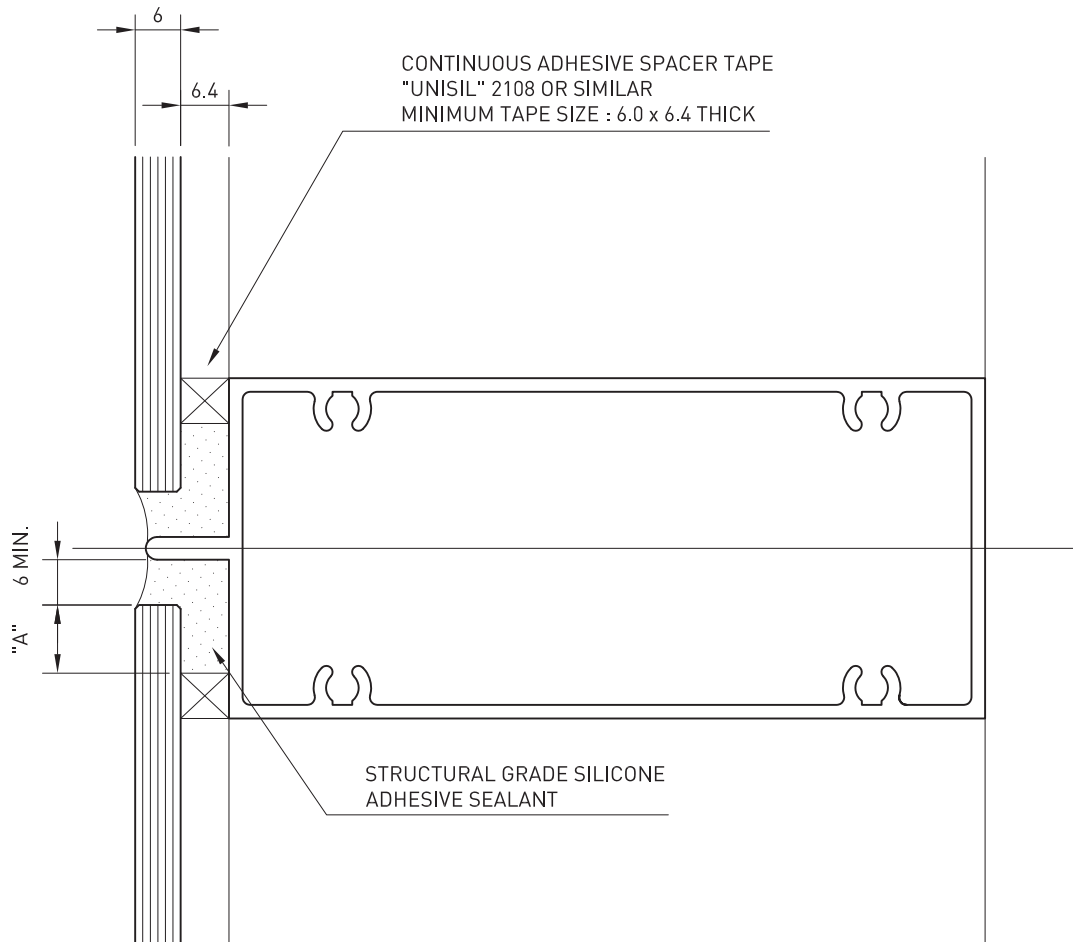

"A" minimum silicone bite size should be 6.0 and is variable within the selected framing to meet the requirements of the design loads.

This detail is intended as a guide to assist in the determination of component dimensions only and does not infer that the technique detailed is the only glazing technique available, requirements for the variation of glazing technique should be referred to design office for clarification.